



REPAIR OF JOINT RIDGING (GA-221-14)

Joint ridging, also called beading, is a uniform, fine linear deformation occurring at gypsum panel product joints. It is usually caused by compression of the edges or ends of the finished and decorated gypsum panel products. **This compression is the result of the edges or ends being forced together from exposure to alternating periods of high and low temperature and humidity extremes.**

Ridging can also be caused by misaligned framing or by repeated changes in temperature or humidity, either of which can induce stresses in the board that are relieved when one or both gypsum boards is compressed and bulge outward at the joint.

In order to permit the wall or ceiling system to stabilize, it is recommended that repairs not begin until the building has gone through at least one complete heating/cooling cycle. Repairs should only be undertaken in a warm, dry environment.

Lightly sand the ridge down, taking care not to damage the embedded joint reinforcing tape. Fill the surface over the area being treated with joint compound, feathering as wide as necessary to create an essentially flat surface. Allow drying-type joint compound to dry for at least 24 hours before proceeding. Setting-type joint compound must be set before proceeding to the next coat of joint compound but must be dry before painting. Refer to the manufacturer's specifications for the setting times of various setting-type joint compounds.

After the joint compound is dry, it may be lightly sanded to feather the edges and remove any remaining tool marks. Examine the sanded area to determine whether or not the ridge has been eliminated. If the examination indicates that the ridge has not been adequately concealed, additional feathering coats of joint compound may be required. Allow each coat of joint compound to dry at least 24 hours before sanding (if not using setting-type compound).

The repaired joint should be painted with a coat of drywall primer and allowed to dry thoroughly prior to the application of final decoration.

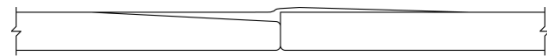

Typical Ridging at Taper-to-Butt Joint



Typical Joint Before Ridging

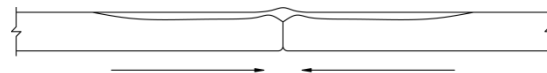

Typical Joint After Ridging

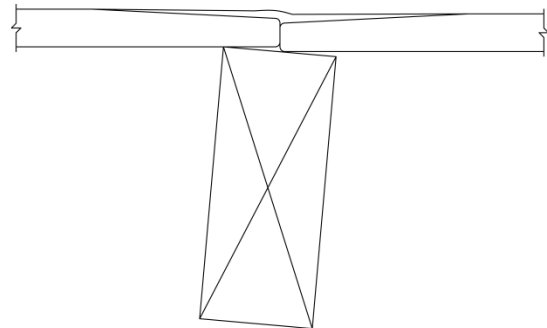

Typical Ridge From Misaligned Framing

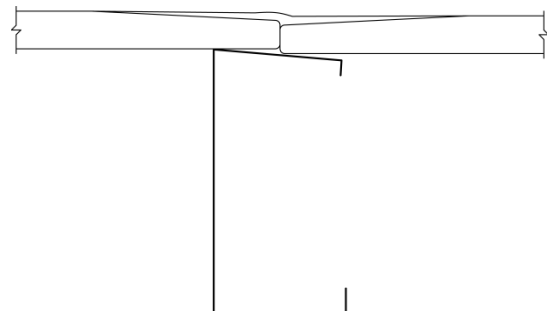

Typical Ridge From Bent Framing

MEMBER COMPANY LIST

2014

AMERICAN GYPSUM COMPANY LLC

CERTAINTEED GYPSUM INC.

CERTAINTEED GYPSUM CANADA INC.

CGC INC.

CONTINENTAL BUILDING PRODUCTS

GEORGIA-PACIFIC GYPSUM LLC

NATIONAL GYPSUM COMPANY

PABCO® GYPSUM

a division of PABCO building products, LLC

UNITED STATES GYPSUM COMPANY



GYPSUM ASSOCIATION

6525 Belcrest Road, #480

Hyattsville, MD 20782

301-277-8686

Fax: 301-277-8747

www.gypsum.org